

OUTSIDE QUICK RELEASE

Installation Instructions

Model Series 7702CB

Position the template (Figure 5) on the outside of your garage door, centered below the opener door bracket.

For a sectional door, position the template 20 to 30 inches below the top of the door. For a one-piece door, position template 15 to 25 inches below the top of the door (refer to illustrations). If your door construction is metal, the template must be positioned so that all the drilled holes will pass through the inside reinforcement stile of the door.

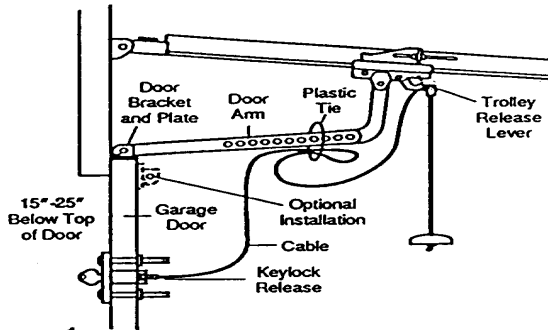

Figure 1

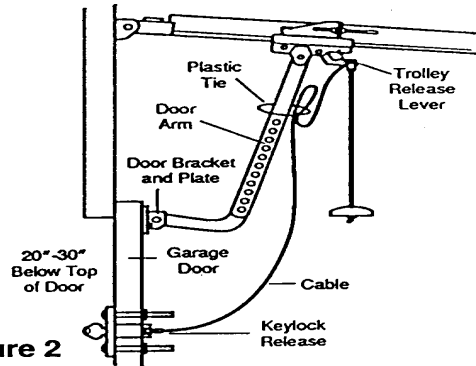

Figure 2

INSTALL OUTSIDE QUICK RELEASE

Fasten template at marked location. Drill a 3/4" diameter hole for the lock and two 1/4" side holes for 1/4"-20x2-1/2" mounting bolts. **Drill all holes completely through the door.**

Uncoil cable attached to end of tumbler. Guide cable through the 3/4" diameter hole from outside the door. Insert the lock assembly and position flush with door.

Insert the two mounting bolts into the side holes from outside of door. Fasten from the inside with 1/4" washers and hex nuts. Tighten nuts securely.

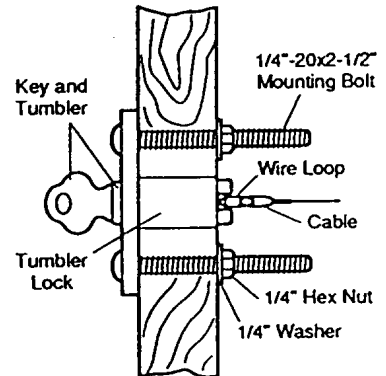

Figure 3

Remove rope from trolley release arm. Place free cable loop over one pin of the master link outside bar as shown.

Securely tie a loop at free end of release rope and place over second pin in outside bar.

Push pin holding cable loop through hole in release arm of trolley. Push cap onto the pins and into pin notches. Be sure cable loop and emergency rope are secured to pins. Slide clip-on spring over cap and lock onto pin notches. Use plastic ties to secure excess cable to door arm.

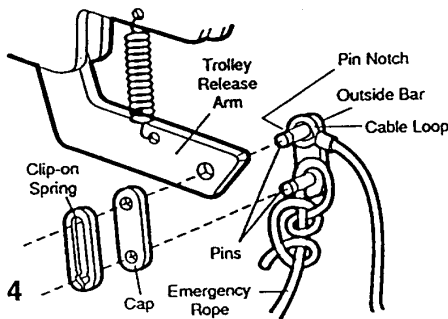

Figure 4

TO OPERATE OUTSIDE QUICK RELEASE: Insert the key into lock and turn clockwise. Remove the key and tumbler from the lock. Pull firmly on the cable (DO NOT PULL ON THE KEY OR TUMBLER). The outer trolley will disconnect from the inner trolley so the door can be opened manually.

Replace tumbler in the lock and remove key. Trolley sections will reconnect automatically when the opener is started.

NOTE: While the trolley is disengaged the garage door may be opened manually. For security, be sure you manually lock garage door.

TEMPLATE FOR DOOR

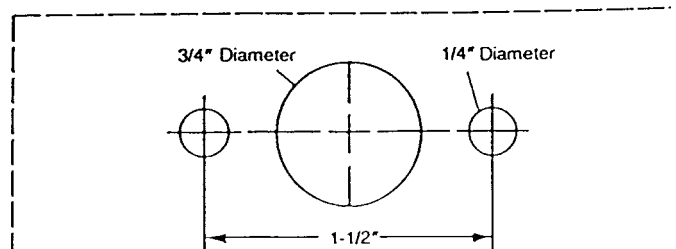

Figure 5