



### WARNING

The Light Control is for indoor use only. Exposure to moisture can cause electric shock or fire.  
Unplug receiver before opening cover to set/change code.

The Plug-In Light Control is designed to operate lights according to the rating chart shown. Please read the instructions and power limitations carefully to ensure proper use and maximum safety. **NOT recommended for use with toasters, coffee pots, or halogen lighting systems.**

This Light Control can be operated by Models 900 Series portable remote controls and Keyless Entries.

**The Plug-In Light Control receiver needs to learn the remote control code. Follow the instructions below:**

- Select a remote control push button to operate the light control.
- Pry up the lower edge of the actuator with a coin or screwdriver as shown.
- Plug the light control into a 120 Vac polarized outlet. The plug contacts are designed for polarized outlets only. The power indicator light will turn on if there is power to the outlet.
- Press and *hold* the remote control push button you chose to activate the light control.
- Then press and release the "Smart" (learn) button on the receiver with a pen or pencil tip. The adjacent yellow indicator light will FLASH once.
- Release the remote control push button. Code setting is now complete. Snap actuator back on light control.

*The remote control push button must be held down until the receiver indicator light flashes for the light control to learn the remote control's code.*

*If the receiver SMART button is pressed and held until the yellow indicator light alongside goes out (in about 6 seconds), **all memorized codes will be erased.***

To comply with FCC rules, adjustment or modification of receiver and/or transmitter is prohibited, except for changing the code setting and replacing the battery. THERE ARE NO OTHER USER SERVICEABLE PARTS.

### RATING

Resistive Load .....	1200 Watts
Motor Load .....	1/3 HP
Incandescent Lamp.....	600 Watts

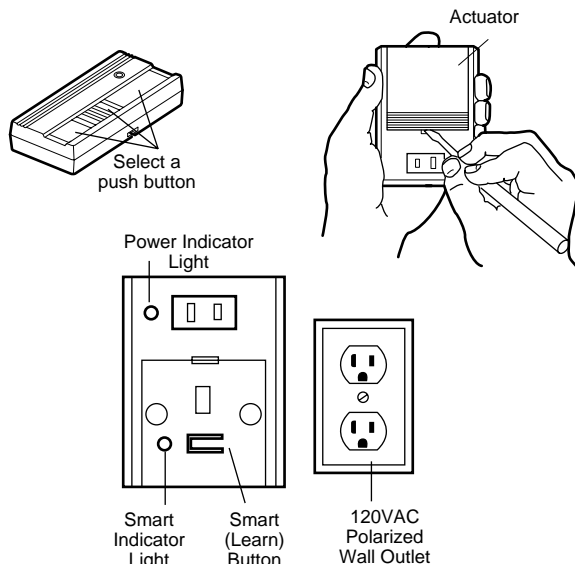

### OPERATING INSTRUCTIONS

***If two or more light products are installed, the receivers must be located at least 10 feet apart to prevent electronic interference.***

- First, plug the lamp into a *wall* outlet and turn it ON.
- With the lamp still in the ON position, plug it into polarized outlet on the light control. The bulb will *not* light.
- TO TEST: Press and release the light control actuator. The light should turn ON. Press the remote control push button. The light should turn OFF.

If the remote control does not activate the light, check to be sure:

- You are pressing the remote control push button selected to operate the light control.
- The remote control battery has power. Refer to the remote control instructions for battery changing information.