

PROGRAMMING YOUR NEW TRANSMITTER FOR GENIE® OPERATORS

1. Open the case, as shown.

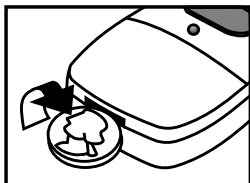

2. For code setting :
Open your existing transmitter, or the cover on receiver located on your operator.
3. If your existing transmitter/receiver has a 9-position DIP switch, just set the

first 9 switches of this new transmitter to match the setting of your existing transmitter/receiver. Make sure you leave the last three switches (position 10 through 12) alone.

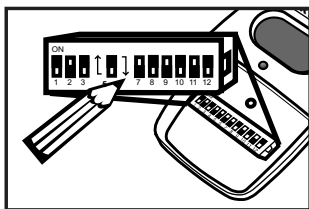

4. If your existing transmitter / receiver has twelve (12) switches, set all switches on your new transmitter to match your existing transmitter / receiver. Then remove and discard the "CODE" jumper block.
5. Test the transmitter and then close the cover.

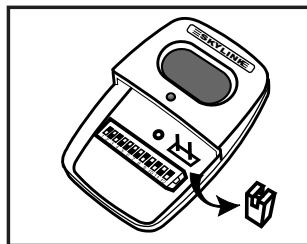

WARNING

If this transmitter triggers other garage doors in your neighbourhood, change all your transmitters and receiver to a new code setting.

DO NOT let children use the garage door transmitter without adult supervision. Children can injure themselves or others by the garage door.

WARRANTY

If, within one year from date of purchase, this product should become defective (except battery), due to faulty workmanship or materials, it will be repaired or replaced, without charge. Proof of purchase is required.

FCC

The Garage Door Remote Control is approved by the FCC and it complies with Part 15 of the FCC Rules. Its operation is subject to the following two conditions :

1. This device may not cause harmful interference.
2. This device must accept any interference that may cause undesired operation.

WARNING:
Changes or modifications to this unit not expressly approved by the party responsible of compliance could void the user's authority to operate the equipment.

BATTERY

Batteries are included with transmitter, to replace :

1. Open the top cover as shown.
2. Remove the screw and lift out the circuit board.
3. Replace two fresh CR2032 lithium batteries, follow the polarity shown on the case.
4. Test the transmitter by pressing the button. Fasten the board onto the case with the screw.

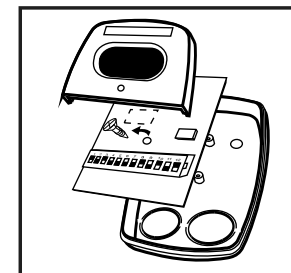

Skylink will not be liable or responsible for any misuse or application of this product other than for its intended use.

CUSTOMER SERVICE
17 Sheard Avenue, Brampton,
Ontario, Canada L6Y 1J3
Fax: (800) 286-1320
Email: support@skylinkhome.com
Customer Service: (800) 304-1187
From 9am to 5pm EST (Mon-Fri)
<http://www.skylinkhome.com>
US Patent. D377458, 5680134,
6005508.

©2005 SKYLINK GROUP
101A035-001

® are registered trademark of their respective corporations

SKYLINK®

**GARAGE DOOR
REMOTE CONTROL**
USER'S INSTRUCTIONS
(MODEL 300G)

